

Zoning Map Categories

- RESIDENTIAL**
- CR** COMPACT RESIDENTIAL (CR 24, 12-24 dwelling units/acre) (CR 32, 24-32 dwelling units/acre)
 - HDR** HIGH DENSITY RESIDENTIAL (12-16 dwelling units/acre) (8-16 dwelling units/acre Station Area Plan)
 - MDR** MEDIUM DENSITY RESIDENTIAL (8-12 dwelling units/acre)
 - VR** VILLAGE RESIDENTIAL (5-8 dwelling units/acre)
 - SR** SURROUNDING RESIDENTIAL (3-6 dwelling units/acre)
 - ER** ESTATE RESIDENTIAL (0.2-3 dwelling units/acre)
- COMMERCIAL DISTRICTS**
- BC** BOULEVARD COMMERCIAL
 - RC** REGIONAL COMMERCIAL
 - NC** NEIGHBORHOOD CENTER COMMERCIAL
 - TC** TOWN CENTER COMMERCIAL
 - CC** COMMUNITY COMMERCIAL
 - SC** SERVICE COMMERCIAL
 - GC** GATEWAY COMMERCIAL
- INDUSTRIAL DISTRICTS**
- LI** LIGHT INDUSTRIAL
 - HI** HEAVY INDUSTRIAL
- SPECIAL PURPOSE DISTRICTS**
- OS** OPEN SPACE
 - PD** PLANNED DEVELOPMENT
 - PI** PUBLIC/INSTITUTIONAL
 - REC** RECREATION

Map Legend

- Town Boundary
- Historic Overlay
- Active Use Frontage Overlay
- Entertainment Overlay
- Office Overlay
- Airport Safety (Portions of Airport Review Area within Town Boundary)
- Flood Hazard (Approximate Location - See FEMA maps on file in the Town Planning Department)
- Station Area Plan Boundary

*Note:
1. Windsor Station Area/Downtown Specific Plan adopted January 18, 2012.

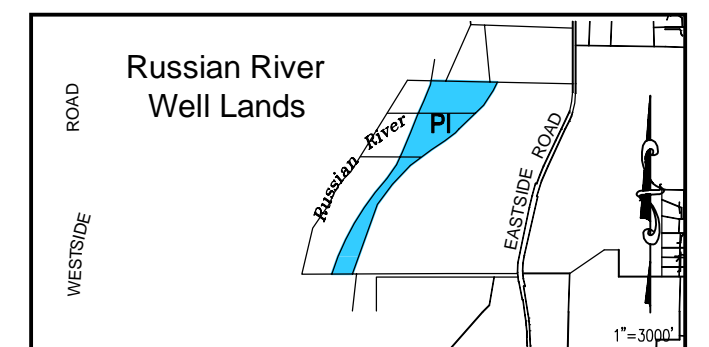
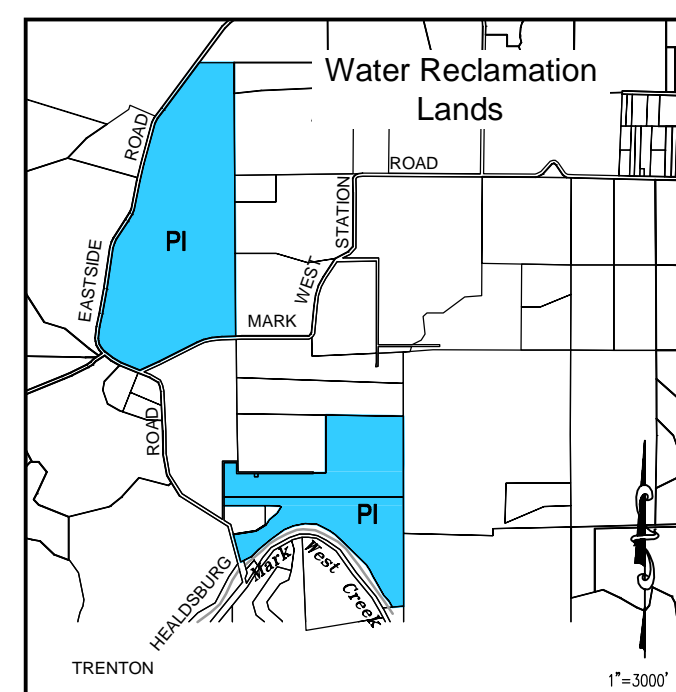

DATE:	May 25, 2000
REVISIONS:	
	FEBRUARY 12, 2002
	APRIL 30, 2003
	NOVEMBER 1, 2005
	AUGUST 2, 2011
	MARCH 6, 2013