

RESOLUTION NO. 2278-08

**A RESOLUTION OF THE TOWN COUNCIL OF THE TOWN OF WINDSOR
ACCEPTING PARTIAL IMPROVEMENTS FOR THE SUBDIVISION IDENTIFIED AS
PARCEL MAP 00-52 HAMPTON INN AND SUITES SUBDIVISION**

WHEREAS, the developer has requested a partial acceptance of a portion of the required public improvements for the subdivision known as Parcel Map 00-52 Hampton Inn and Suites Subdivision; and

WHEREAS, the Town Engineer has determined that a portion of required public improvements for the subdivision known as Parcel Map 00-52 Hampton Inn and Suites Subdivision has been completed on or about August 2005; and

WHEREAS, the public improvements to be accepted are on Brooks Road South and a portion of Los Amigos Road and identified on Exhibit A (sheets 1 through 4);

NOW, THEREFORE BE IT RESOLVED that the Town Council of the Town of Windsor hereby accepts the partial improvements for the Hampton Inn and Suites Subdivision, as shown on Exhibit "A", and shall assume responsibility for the future maintenance and repair thereof; and

BE IT FURTHER RESOLVED that the Town Council of the Town of Windsor approves the release of the original bonds dated August 10, 2004.

PASSED, APPROVED AND ADOPTED this 21st day of May 2008 by the following vote:

AYES:	COUNCILMEMBERS ALLEN, GOBLE, PARKER, SALMON AND MAYOR FUDGE
NOES:	NONE
ABSTAIN:	NONE
ABSENT:	NONE



DEBORA FUDGE, MAYOR

ATTEST:



MARIA DE LA O, TOWN CLERK

Attachment:
Exhibit A

EXHIBIT A

PARTIAL ACCEPTANCE PLANS
IMPROVEMENT PLANS
OF

HAMPTON INN AND SUITES

SUBDIVISION

MNS NO. 00-52

8937 BROOKS ROAD SOUTH

TOWN OF WINDSOR - CALIFORNIA

MARCH 2004

INDEX OF DRAWINGS

- SOIL DRAWINGS
- INDEX OF DRAWINGS
- NOTES & AMENDMENTS
- BROOKS ROAD SOUTH PLAN & PROFILE, STAGE TO 14+50
- NEW LOS AMIGOS ROAD PLAN & PROFILE, STAGE TO 17+50
- NEW LOS AMIGOS ROAD PLAN & PROFILE, STAGE TO 17+50
- DETAILS AND CROSS SECTIONS, BROOKS ROAD SOUTH
- WINDSOR STANDARD DETAILS
- WINDSOR STANDARD DETAILS
- WINDSOR STANDARD DETAILS
- DETAILS AND CROSS SECTIONS, BROOKS ROAD SOUTH
- GRADING PLAN
- SEWER PLAN
- UTILITY PLAN
- LAYOUT AND EROSION CONTROL PLAN
- LAYOUT AND EROSION CONTROL PLAN
- SEWER & STRIPING PLAN
- CONSTRUCTION MARKING
- BRIDGE TUBULAR ROAD RAILING - PLACEMENT AND DETAILS
- BRIDGE DECK
- LANDSCAPE DRAINAGE
- TRAFFIC SIGNAL MODIFICATION
- NEW STAKE ARCH PLANS

THE CONTRACTOR UNDER EXHIBIT A
PLANS FOR THE IMPROVEMENT AND
CONSTRUCTION OF THE PROJECT IS
NOT RESPONSIBLE FOR THE
ACCURACY OF THE DATA OR
THE RESULTS OF THE SURVEY
CONDUCTED BY THE ENGINEER
ON APRIL 7, 2004

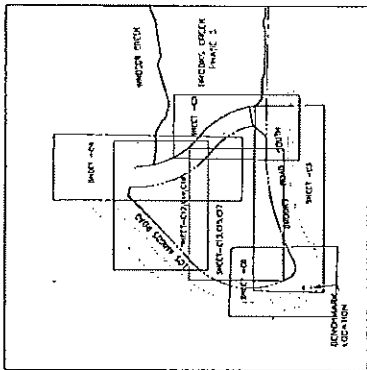

THE ONLY TRIMMED BEAMS MUST BE
RETAINED & APPROVED BY THE PLANNING
DEPARTMENT PRIOR TO INSTALLATION.

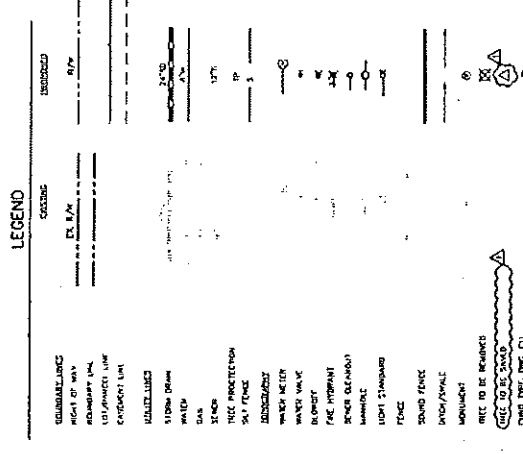

PROJECT BENCHMARK
IN 2001, A CHECKED SOLARIC ON THE TOP OF CURB NEAR THE CURB BETWEEN
LOS AMIGOS ROAD AND THE SOUTHWESTERN CORNER OF BROOKS ROAD AND LOS
AMIGOS ROAD, ELEV. 116.25
BY BUREAU OF SURVEYING ENGINEERING, TOPG SUPPLEMENTED
BY BREKLE & RACE SURVEY

BASIS OF BEARINGS
THE CENTERLINE OF BROOKS ROAD BETWEEN MONUMENTS MARKING THE
WEST ANCHOR POINT OF CURVE ON BROOKS ROAD AND THE CENTER OF SECTION IS
AS PER THE FOLLOWING HORIZONTAL ADJUSTED SUBSTATION MAP FOR SURVEY DATA NOT SHOWN HEREIN.

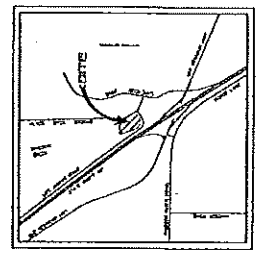

KEY MAP
NOT TO SCALE

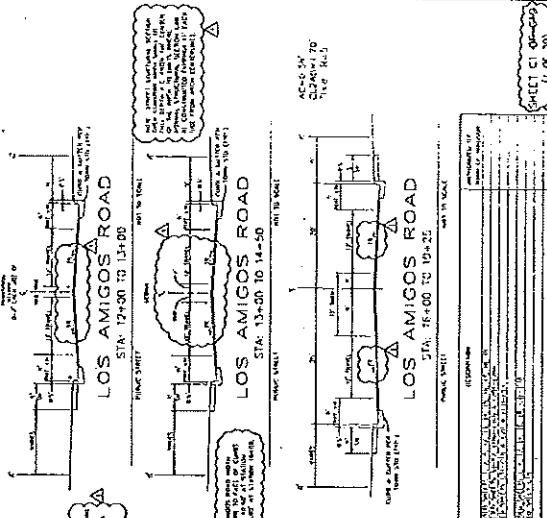
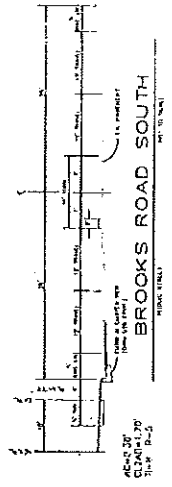

BREKLE & RACE
CONSULTING ENGINEERS
1100 W. 17th Street, Suite 200
Brea, CA 92625
Tel: 949/766-8888
Fax: 949/766-8889

MILL BRUSHMAN
REGISTERED PROFESSIONAL ENGINEER
No. 45104
Civil

HOWARD W. SMITH, M.S., C.E., STAGE ONE
REGISTERED PROFESSIONAL ENGINEER
No. 45104
Civil

EXHIBIT A

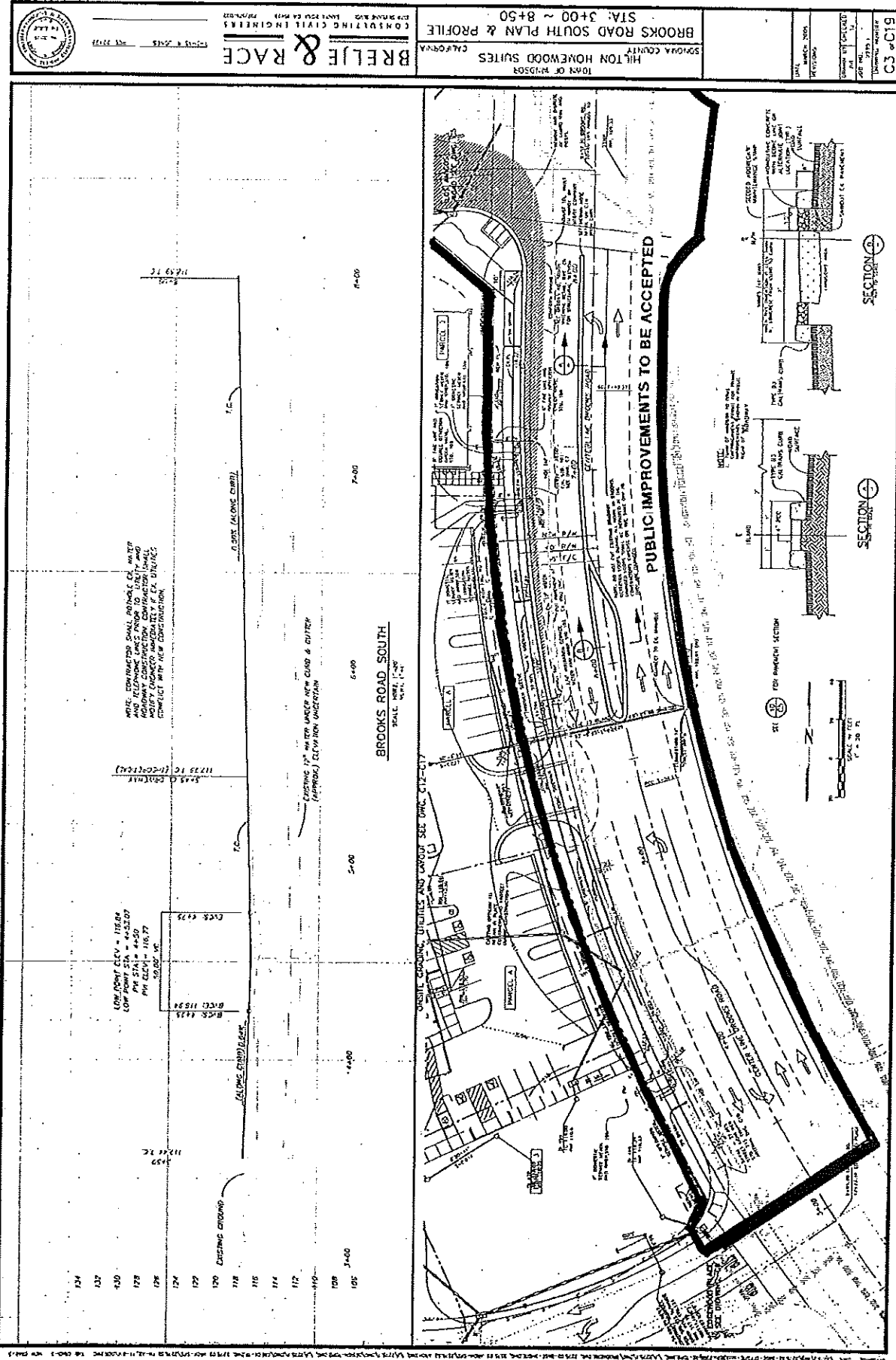

EXHIBIT A

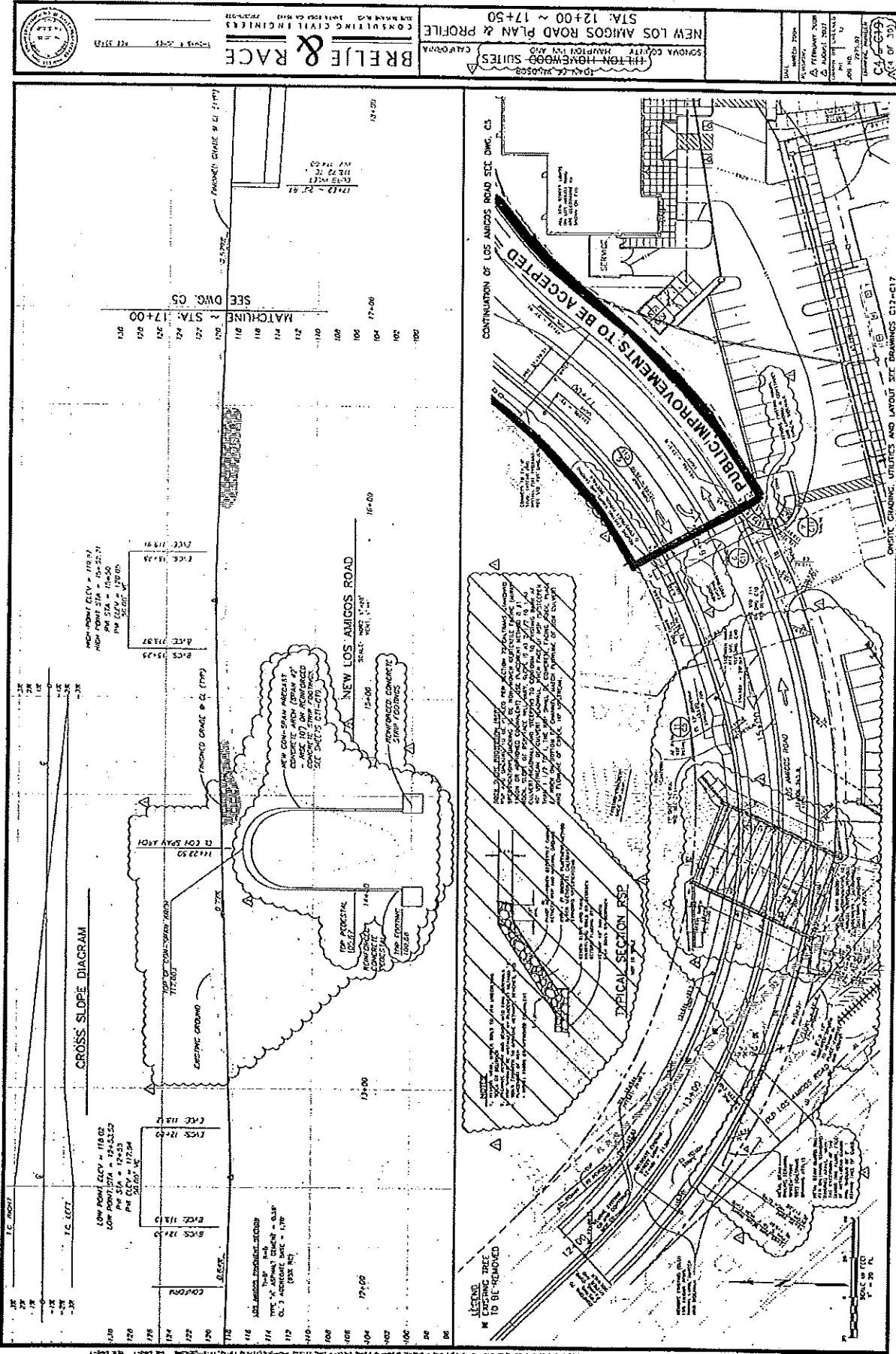



EXHIBIT A

BREJLE & RACE
 CONSULTING CIVIL ENGINEERS
 1700 S. 24th St., Suite 200
 San Jose, CA 95128
 (408) 298-1111

10471 OF 110503
 HILTON HOMEWOOD SUITES
 SJOVIA COUNTY
 NEW LOS AMIGOS ROAD PLAN & PROFILE
 STA. 17+50 ~ 20+00
 DATE: 11/11/11
 DRAWN BY: J. RACE
 CHECKED BY: J. RACE
 PROJECT NO.: 11111111
 SHEET NO.: 11111111
 TOTAL SHEETS: 11111111
 CS 111111

